

INDEX TO BUILDINGS

- | | |
|------------------------------------|--|
| 1 ADMINISTRATION BUILDING | THE LITTLE CAMPUS |
| 2 GENERAL LIBRARY | 50 MENS DORMITORY |
| 3 SPECIAL LIBRARY | 51 MENS DORMITORY & MANAGERS RESIDENCE |
| 4 SUTTON HALL | 52 MENS DORMITORY & STORE ROOM |
| 5 ARCHITECTURE BLDG | 53 DIVISION OF EXTENSION |
| 6 UNION BUILDING | 54 BUREAU OF ECONOMIC GEOLOGY & BUREAU OF ENGINEERING RESEARCH |
| 7 MODERN LANGUAGES BLDG | 55 U.S. DEPARTMENT OF AGRICULTURE |
| 8 HOGG MEMORIAL AUDITORIUM | 56 POWER HOUSE |
| 9 JOURNALISM BUILDING | 57 BUREAU OF ECONOMIC GEOLOGY |
| 10 BIOLOGY BUILDING | |
| 11 HOME ECONOMICS BLDG | |
| 12 PHYSICS BUILDING | |
| 13 CHEMISTRY BUILDING | |
| 14 PRESS BUILDING | |
| 15 WAGGENER HALL | |
| 16 LAW BUILDING | |
| 17 GARRISON HALL | |
| 18 GEOLOGY BUILDING | |
| 19 ALICE LITTLEFIELD MEMORIAL DORM | |
| 20 ASENATH CAROTHERS DORMITORY | |
| 21 JESSIE ANDREWS DORMITORY | |
| 22 WOMANS GYMNASIUM | |
| 23 ENGINEERING BUILDING | |
| 24 POWER BUILDING | |
| 25 SPRAY POND | |
| 26 GREGORY GYMNASIUM | 37 HILL HALL |
| 27 BRACKENRIDGE | 38 HOME ECONOMICS TEA HOUSE |
| 28 PEATHER HALL | 39 CHEMICAL ENG BLDG |
| 29 ROBERTS HALL | 40 PETROLEUM ENG BLDG |
| 30 TEXAS MEMORIAL STADIUM | 41 MUSIC BUILDING |
| 31 CLARK FIELD | 42 BRUCCELLO'S LAB |
| 32 TEXAS MEMORIAL MUSEUM | 43 BIOLOGY GREENHOUSE |
| 33 UNIVERSITY JUNIOR HIGH SCHOOL | |
| 34 LITTLEFIELD MEMORIAL FOUNTAIN | |
| 35 LITTLEFIELD HOME | |
| 36 RADIO HOUSE | 44 OLD B HALL |

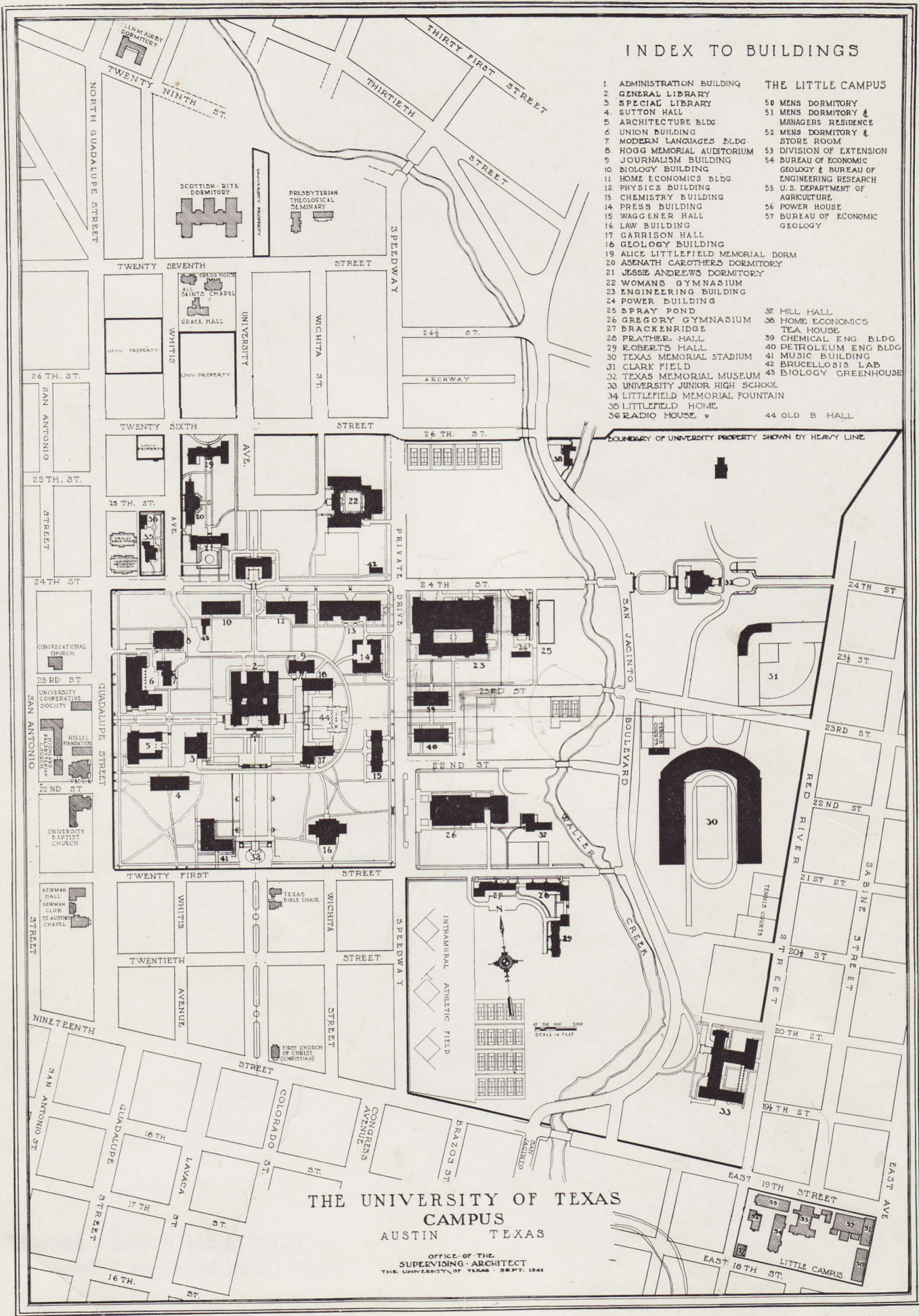

THE UNIVERSITY OF TEXAS
 CAMPUS
 AUSTIN TEXAS
 OFFICE OF THE SUPERVISING ARCHITECT
 THE UNIVERSITY OF TEXAS - SEPT. 1941

1941